

CANTON

CANTON CORNERS
Ford & Lilley Road
Canton, MI 48187



DEMOGRAPHICS

	3 mi	5 mi	10 mi
Pop	94,341	111,446	434,267
HH	36,792	46,289	174,432
Ave HH Income	\$98,466	\$95,072	\$86,073

TOTAL CENTER GLA: 194,349 sf

TRAFFIC COUNTS

Ford Road 39,400
Lilley Road 16,131

PROPERTY FEATURES

Located at the southwest corner of Ford Rd. and Lilley Rd., Canton Corners is on one of the busiest stretches of retail in southeast Michigan. Just a few minutes from I-275, I-96, and M-14, Canton has a population of 111,446 and an average household income of \$95,072.

Local retailers include: IKEA, Kohl's, Target, Walmart, Sam's Club, Meijer, and Home Depot.

Schostak
BROTHERS & COMPANY
www.schostak.com

Justine O'Brien

(248) 357-6220 obrien@schostak.com
17800 Laurel Park Drive, N. - Suite 200C
Livonia, MI 48152



Scan the QR Code for a list of our other properties!



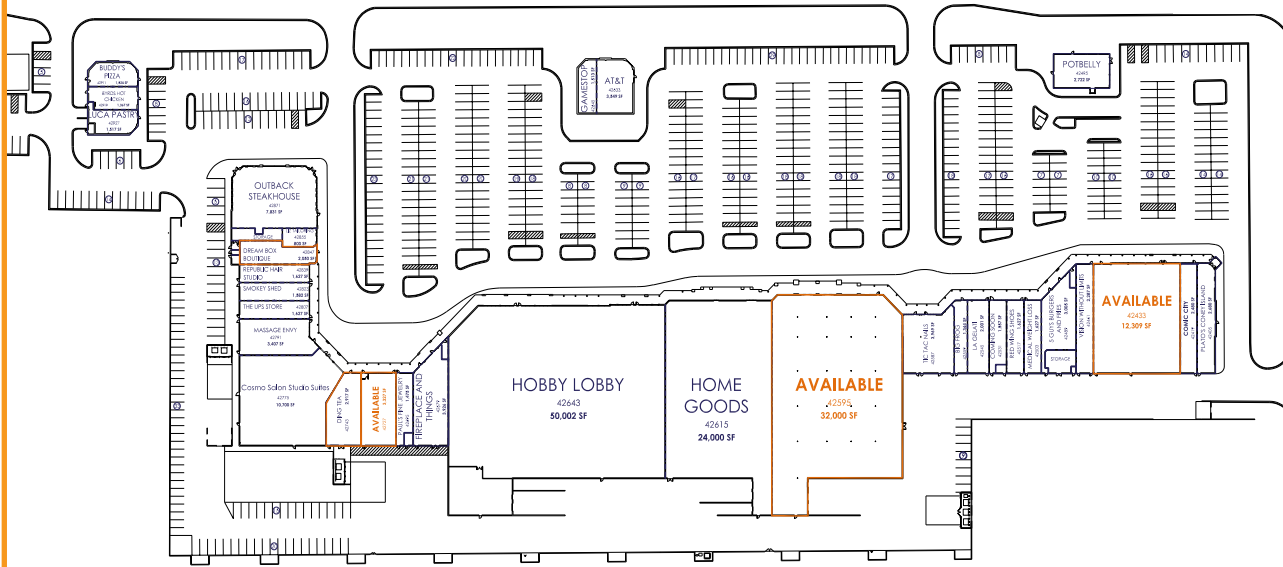

SUITE	TENANT	SQFT
42911	Buddy's Pizza	1,524
42919	Byrd's Hot Chicken	1,367
42927	Luca Pastry	1,517
42645	GameStop	1,513
42633	AT&T	3,549
42495	Potbelly Sandwich Works	2,722
42871	Outback Steakhouse	7,831
42855	Liz Tailoring	800
42847	Dream Box Boutique	2,050
42839	Republic Hair Studio	1,627
42823	Smokey Shed	1,582
42807	The UPS Store	1,627

SUITE	TENANT	SQFT
42791	Massage Envy	3,407
42775	Cosmo Salon Studio Suites	10,700
42743	Ding Tea	2,917
42727	AVAILABLE	3,327
42695	Paul's Fine Jewelry	1,475
42679	Fireplace and Things	3,926
42643	Hobby Lobby	50,002
42615	Home Goods	24,000
42595	AVAILABLE	32,000
42587	Tic Tac Nails	3,969

SUITE	TENANT	SQFT
42559	Big Frog	1,344
42545	La Gelati	2,001
42531	Coming Soon	1,557
42517	Red Wing Shoes	1,627
42503	Medical Weight Loss	1,627
42489	5 Guys Burgers & Fries	3,005
42461	Vision Without Limits	2,287
42433	AVAILABLE	12,309
42419	Comic City	2,480
42405	Plato's Coney Island	2,680

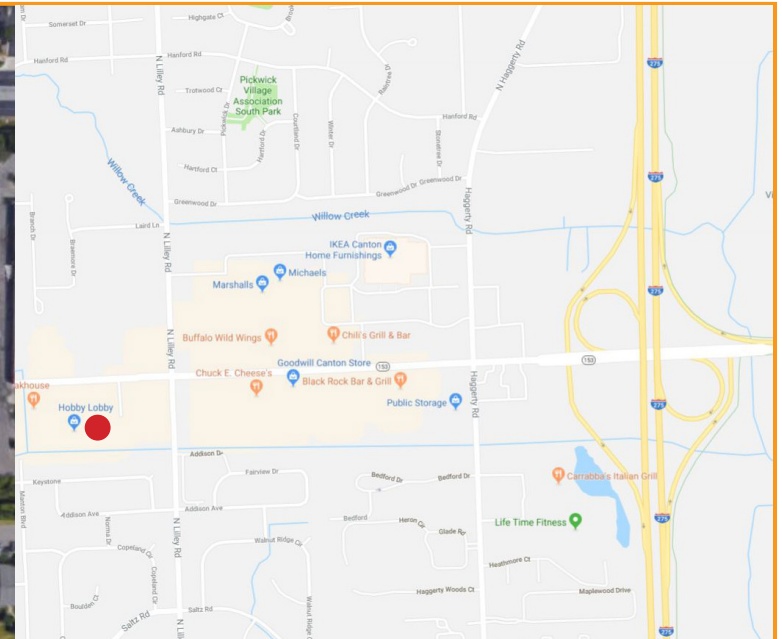

CANTON

CANTON CORNERS
 Ford & Lilley Road
 Canton, MI 48187