

ST. JOHNS

ST. JOHNS SHOPPING CENTER
2445 Ontario Drive
St. Johns, MI 48879



DEMOGRAPHICS:

	3 MI	5 MI	15 MI
Pop	10,315	12,578	85,737
HH	4,269	5,087	33,778
Ave HH Inc	\$91,452	\$95,610	\$107,611
Total Employees	4,090	4,330	25,500

PROPERTY FEATURES

Shadow Anchored by SuperWalmart, St. John's Shopping Center has a strong mix of both national and regional tenants including Dollar Tree, Snap Fitness, AT&T, and Jet's Pizza.

St. John's is situated in the heart of Clinton County and is home to Clinton Regional Hospital and the home of a 360,000/SF milk manufacturing facility and a separate 85,000/SF protein processing plant.



Josh Schostak

(248) 357-6151 joshschostak@schostak.com

17800 Laurel Park Drive, N. - Suite 200C

Livonia, MI 48152



Scan the QR Code for a list of our other properties!



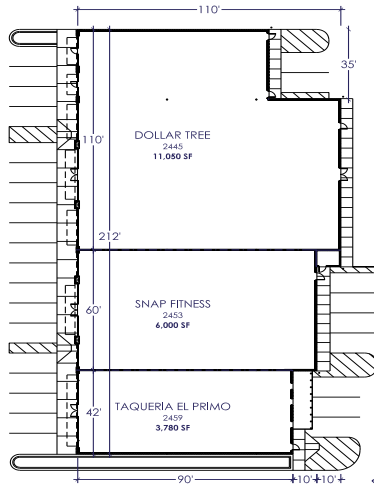
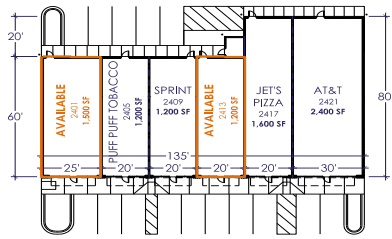

WALMART SUPERCENTER

SPACE	TENANT	SQFT
2401	Available	1,500
2405	Puff Puff Tobacco	1,200
2409	Sprint	1,200
2413	Available	1,200
2417	Jet's Pizza	1,600
2421	AT&T	2,400
2445	Dollar Tree	11,050
2453	Snap Fitness	6,000
2459	Taqueria El Primo	3,780

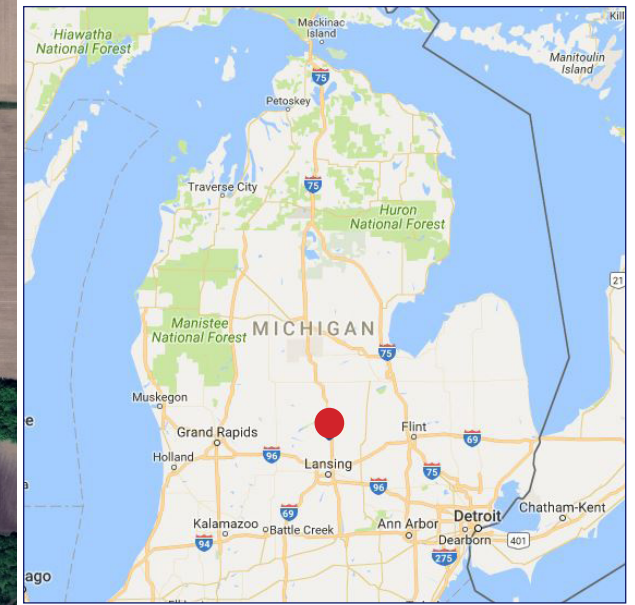
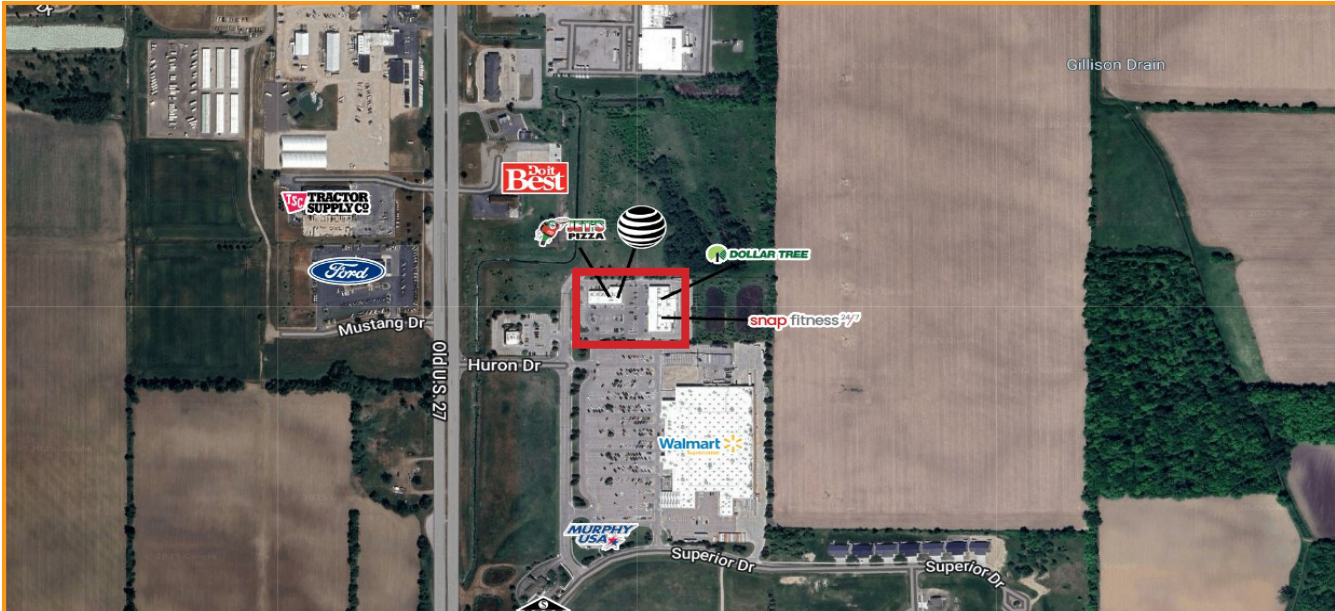

ST. JOHNS

ST. JOHNS SHOPPING CENTER
 2445 Ontario Drive
 St. Johns, MI 48879